

**AD 2. AERODROMES****SUPE AD 2.11-1 AERODROME LOCATION INDICATOR AND NAME**

SUPE - PUNTA DEL ESTE/Departamental "El Jagüel"

**SUPE 2.11-2 AERODROME GEOGRAPHICAL AND ADMINISTRATIVE DATA**

1	<i>ARP coordinates and site at AD</i>	345447S 0545509W 20 M E from TWR
2	<i>Direction and distance from (city)</i>	6 KM NE from the city of Punta del Este
3	<i>Elevation/Reference temperature</i>	20 M (66 FT) / 25°C
4	<i>Geoid undulation at AD ELEV PSN</i>	13 M
5	<i>MAG VAR/Annual change</i>	11° W (JAN 2015) / 0.15° increasing
6	<i>AD operator, address, telephone, telefax, e-mail address, AFS address, website address</i>	Dirección Nacional de Aviación Civil e Infraestructura Aeronáutica Aeropuerto Dptal. de Punta del Este "El Jagüel" Maldonado Tel: 4248 4513 Telefax: 4248 4513 e-mail: supe@dinacia.gub.uy AFS: SUPEYTYX
7	<i>Types of traffic permitted (IFR/VFR)</i>	VFR
8	<i>Remarks</i>	Nil

**SUPE AD 2.11-3 OPERATIONAL HOURS**

1	<i>AD Operator</i>	DLY from 11:00 UTC to SS.
2	<i>Customs and immigration</i>	Nil
3	<i>Health and sanitation</i>	In the city of Punta del Este and Maldonado
4	<i>AIS Briefing Office</i>	Nil
5	<i>ATS Reporting Office (ARO)</i>	Nil
6	<i>MET Briefing Office</i>	Nil
7	<i>ATS</i>	Nil
8	<i>Fuelling</i>	As AD Operator
9	<i>Handling</i>	Nil
10	<i>Security</i>	Nil
11	<i>De-icing</i>	Nil
12	<i>Remarks</i>	Nil

**SUPE AD 2.11-4 HANDLING SERVICES AND FACILITIES**

1	<i>Cargo-handling facilities</i>	On behalf of transportation companies
2	<i>Fuel/oil types</i>	Fuel 100/130, JET A-1 / Oil: Nil
3	<i>Fuelling facilities/capacity</i>	100/130: 15 000 L JET A-1: 10 000 L
4	<i>De-icing facilities</i>	Nil
5	<i>Hangar space for visiting aircraft</i>	Nil
6	<i>Repair facilities for visiting aircraft</i>	Nil
7	<i>Remarks</i>	Limited refuelling of up to 5,700 Kg ACFT

**SUPE AD 2.11-5 PASSENGER FACILITIES**

1	<i>Hotels</i>	In the city of Punta del Este and Maldonado
2	<i>Restaurants</i>	Bar, restaurant and confectionery service during summer time.
3	<i>Transportation</i>	Bus and taxis service
4	<i>Medical facilities</i>	In the city of Punta del Este and Maldonado
5	<i>Bank and Post Office</i>	Nil
6	<i>Tourist Office</i>	Nil
7	<i>Remarks</i>	Nil

**SUPE AD 2.11-6 RESCUE AND FIRE FIGHTING SERVICES**

1	<i>AD category for fire fighting</i>	☛ Nil
2	<i>Rescue equipment</i>	Nil
3	<i>Capability for removal of disabled aircraft</i>	Nil
4	<i>Remarks</i>	Nil

**SUPE AD 2.11-7 SEASONAL AVAILABILITY - CLEARING**

1	<i>Types of clearing equipment</i>	Nil
---	------------------------------------	-----

**SUPE AD 2.11-8 APRONS, TAXIWAYS AND CHECK LOCATIONS/POSITIONS DATA**

1	<i>Apron surface and strength</i>	Surface: asphalt concrete Strength: No data
2	<i>Taxiway width, surface and strength</i>	Width: 23 M Surface: asphalt concrete Strength: No data
3	<i>Altimeter checkpoint location and elevation</i>	Terminal apron (345451S/0545506W) 15 M
4	<i>VOR/INS checkpoints</i>	Nil
5	<i>Remarks</i>	Nil

**SUPE AD 2.11-9 SURFACE MOVEMENT GUIDANCE AND CONTROL SYSTEM AND MARKINGS**

1	<i>Use of aircraft stand ID signs, TWY guide lines and visual docking/parking guidance system of aircraft stands</i>	Nil
2	<i>RWY and TWY markings and LGT</i>	RWY: Designation, centre line, THR of RWY and fix distances TWY: Designation of centre line, holding points
3	<i>Stop bars</i>	Stop bars on TWY
4	<i>Remarks</i>	Nil

**SUPE AD 2.11-10 AERODROME OBSTACLES**

<i>In approach/TKOF areas</i>			<i>In circling area and at AD</i>		<i>Remarks</i>
1			2		3
<i>RWY/Area affected</i>	<i>Obstacle type Elevation Markings/LGT</i>	<i>Coordinates</i>	<i>Obstacle type Elevation Markings/LG</i>	<i>Coordinates</i>	Nil
a	b	c	a	b	
19/APCH	Tree 57 M 190°  Antenna 32 M 167°		Grinder 40 M 188°  Antenna 193 M (MSL) LGT	345139S 0545719W(*)	

**SUPE AD 2.11-11 METEOROLOGICAL INFORMATION PROVIDED**

1	<i>Associated MET Office</i>	MALDONADO LAGUNA
2	<i>Hours of service MET Office outside hours</i>	As AD Operator -
3	<i>Office responsible for TAF preparation Periods of validity</i>	Surveillance MET Office CARRASCO H 24
4	<i>Trend forecast Interval of issuance</i>	O/R
5	<i>Briefing/consultation provided</i>	Personal inquiries: High season Low season O/R
6	<i>Flight documentation Language(s) used</i>	Chart, En-Route chart (provided in high season) Spanish
7	<i>Charts and other information available for briefing or consultation</i>	S, U, P, T (high season)
8	<i>Supplementary equipment available for providing information</i>	Nil
9	<i>ATS units provided with information</i>	Nil
10	<i>Additional information (limitation of service, etc.)</i>	Nil

**SUPE AD 2.11-12 RUNWAY PHYSICAL CHARACTERISTICS**

<i>Designations RWY NR</i>	<i>TRUE BRG</i>	<i>Dimensions of RWY (M)</i>	<i>Strength (PCN) and surface of RWY and SWY</i>	<i>THR coordinates. RWY end coordinates. THR geoid undulation</i>	<i>THR elevation and highest elevation of TDZ of precision APP RWY</i>
1	2	3	4	5	6
01	004°	840 x 20	- Asphalt concrete	345443.06S 0545513.53W 345453.84S 0545514.48W GUND 12.6 M	THR 20 M/66 FT
19	184°	840 x 20	- Asphalt concrete	345424.62S 0545511.68W 345424.62S 0545511.68W GUND 12.6 M	THR 10 M/33 FT TDZ 16 M/53 FT
<i>Slope of RWY-SWY</i>	<i>SWY dimensions (M)</i>	<i>CWY dimensions (M)</i>	<i>Strip dimensions (M)</i>	<i>OFZ</i>	<i>Remarks</i>
7	8	9	10	11	12
-1%/+1%/-0.72% (65 M) (85 M) (690 M)	Nil	Nil	Nil	Nil	Nil
+0.72%/-1%/+1% (690 M) (85 M) (65 M)	Nil	Nil	Nil	Nil	Nil

**SUPE AD 2.11-13 DECLARED DISTANCES**

<i>RWY Designator</i>	<i>TORA (M)</i>	<i>TODA (M)</i>	<i>ASDA (M)</i>	<i>LDA (M)</i>	<i>Remarks</i>
1	2	3	4	5	6
01	840	840	840	570	☛ Nil
19	570	570	840	840	☛ Nil

**SUPE AD 2.11-14 APPROACH AND RUNWAY LIGHTING**

<i>RWY Desig- nator</i>	<i>APCH LGT type LEN INTST</i>	<i>THR LGT colour WBAR</i>	<i>VASIS (MEHT) PAPI</i>	<i>TDZ, LGT LEN</i>	<i>RWY Centre Line LGT Length, spacing, colour, INTST</i>	<i>RWY edge LGT LEN, spacing colour INTST</i>	<i>RWY End LGT colour WBAR</i>	<i>SWY LGT LEN (M) colour</i>	<i>Remarks</i>
1	2	3	4	5	6	7	8	9	10
01	Nil	Green Red	Nil	Nil	Nil	☛ 840 M, 60 M White	- White Amber	Nil	Nil
19	Nil	Green Red	Nil	Nil	Nil	☛ 840 M, 60 M White	- White Amber	Nil	Nil

**SUPE AD 2.11-15 OTHER LIGHTING, SECONDARY POWER SUPPLY**

1	<i>ABN/IBN location, characteristics and hours of operation</i>	ABN: Building TWR/ IBN: Nil
2	<i>LDI location and LGT Anemometer location and LGT</i>	WDI: 394 M N from ARP, not lighted Anemometer: a 100 M from RWY axis
3	<i>TWY edge and centre line lighting</i>	Edge: all the TWY Centre: Nil
4	<i>Secondary power supply/switch-over time</i>	Secondary power supply: 26 KW (automatic manual) for the entire aerodrome.
5	<i>Remarks</i>	Nil

**SUPE AD 2.11-16 HELICOPTER LANDING AREA**

1	<i>Coordinates TLOF or THR of FATO</i>	Nil
2	<i>TLOF and/or FATO elevation M/FT</i>	Nil
3	<i>TLOF and FATO area dimensions, surface, strength, marking</i>	Nil
4	<i>True and MAG BRG FATO</i>	Nil
5	<i>Declared distance available</i>	Nil
6	<i>APP and FATO lighting</i>	Nil
7	<i>Remarks</i>	Nil

**SUPE AD 2.11-17 ATS AIRSPACE**

1	<i>Designation and lateral limits</i>	PUNTA DEL ESTE ATZ Circle, radius 3 NM centred at 345447S/ 0545509W.
2	<i>Vertical limits</i>	GND up to 300 M
3	<i>Airspace classification</i>	☛ G
4	<i>ATS unit call sign Language(s)</i>	☛ Nil Spanish
5	<i>Transition altitude</i>	900 M
6	<i>Remarks</i>	☛ See page AD 2.11-19 "SUPE AD 2.11-20 LOCAL TRAFFIC ☛ REGULATIONS

**SUPE AD 2.11-18 ATS COMMUNICATION FACILITIES**

<i>Service designation</i>	<i>Call sign</i>	<i>Frequency</i>	<i>Hours of operation</i>	<i>Remarks</i>
1	2	3	4	5
NIL	NIL	118.7 MHZ	As AD	Nil
NIL	NIL	NIL	NIL	NIL

SUPE AD 2.11-19 RADIO NAVIGATION AND LANDING AIDS

<i>Type of aid, MAG VAR, Type of supported OP (for VOR/ILS/MLS, give declination)</i>	<i>ID</i>	<i>Frequency</i>	<i>Hours of operation</i>	<i>Position of transmitting antenna coordinates</i>	<i>Elevation of DME transmitting antenna</i>	<i>Remarks</i>
1	2	3	4	5	6	7
NIL						



## SUPE AD 2.11-20 LOCAL TRAFFIC REGULATIONS

### 1. General

Punta del Este "El Jagüel" Dptal Airport. is an uncontrolled aerodrome and operated exclusively for VFR flights. VFR transit departing or arriving, shall comply with the Flight General Rules set out in LAR91.

Aircraft on arrival receive traffic information and aerodrome available for Curbelo Tower 118.3 MHz frequency and will be guided by it to the limits of ATZ Punta del Este "El Jagüel" Dptal airport.

By entering the "El Jagüel" ATZ aircrafts change frequency to 118.7 MHz and issue a message informing its position in the air, which will also do entering the holding pattern for runway in use, turning to the final track and when they leave the runway. The manoeuvres in the ATZ, the traffic pattern and landing, are the responsibility of the pilot in command.

Aircraft departure, issued a message to air traffic reporting their intentions, so will before entering the runway before takeoff. The taxiway and takeoff manoeuvres are the responsibility of the pilot in command.

Aircrafts departing and foreseeing affect Carrasco TMA or airspace class "C" shall:

- 1) before starting engines, call by phone to SULLS TWR to obtain the approval of the Flight Plan and the Transponder Code; and
- 2) before take-off, call by phone to SULLS TWR (42559904) to obtain instructions to overfly Carrasco TMA.

All flights shall comply with the filing of flight plan according to current regulations.

It is recalled that in Punta del Este "The Jagüel" Dptal Airport the circuit pattern for runway 01 will be carried out exclusively by right.

Caution is advised on final approach to Runway 01 and climb on takeoff from Runway 19 for the presence of natural obstacles (trees) in the vicinity of THR 01.

### 2. Airport Regulation

Aerodrome available for general public use permitted only daytime operations.

### 3. Limitations of use

Aerodrome is licensed for use for aircraft maximum takeoff weight (MTOW) of up to 5,700 KG.

### 4. Minimum vertical separation in the Traffic Circuit of Punta del Este.

Nil.

**SUPE AD 2.11-24 CHARTS RELATED TO AN AERODROME**

Aerodrome/Heliport Chart – ICAO ..... AD 2.11-11

AERODROME/HELIPORT  
CHART - ICAO

34°54'47"S ELEV 20  
054°55'09"W (66)

TWR 118.7  
APRON 000.0

PUNTA DEL ESTE/  
Dptal. El Jagüel

RWY	DIRECTION	THR	GUND	BEARING STRENGTH
01	013°	34°54'43.06"S 54°55'13.53"W	12.6 M	Runway, Apron and Taxiway
19	193°	34°54'24.62"S 54°55'11.68"W	12.6 M	No data

ELEVATIONS IN METRES (AND FEET)  
DIMENSIONS IN METRES  
BEARINGS ARE MAGNETIC

TAXIWAYS 23 WIDE

VAR 11° W - 2015  
ANNUAL RATE 9  
OF CHANGE

WDI

6L

ELEV 10 (33)  
TDZ ELEV 16 (53)

840 x 20 ASPHALTIC CONCRETE  
ELEV 15 (49)

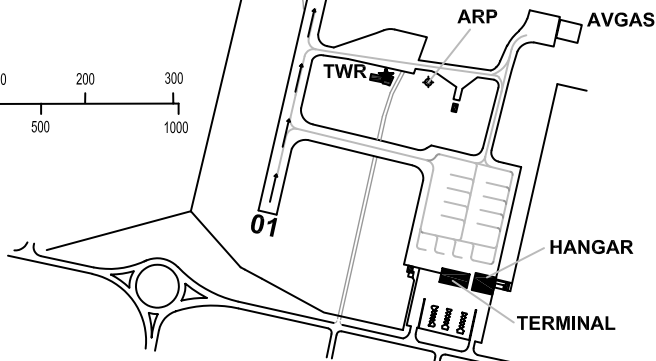
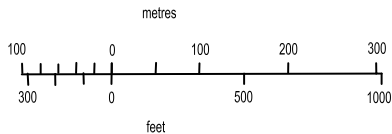

Change: VAR, delete Limitations of use

MARKING AIDS RWY 01/19 AND EXIT TWY

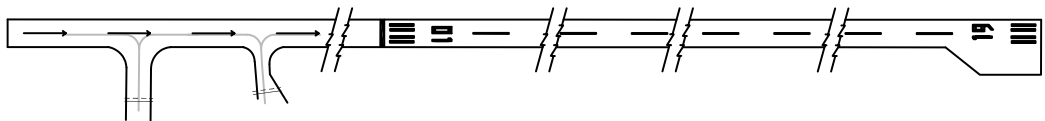

LIGHTING AIDS RWY 01/19 AND EXIT TWY

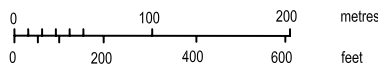
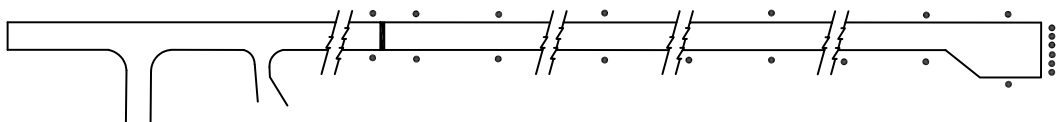

**INTENTIONALLY  
LEFT BLANK**